

**RED RIVER ROAD:
AS THE ORIGINS OF THE
DAWSON TRAIL, THIS
ROUTE IS A HINGE POINT
IN BOTH CANADA'S
GEOGRAPHY AND ITS
HISTORY.**

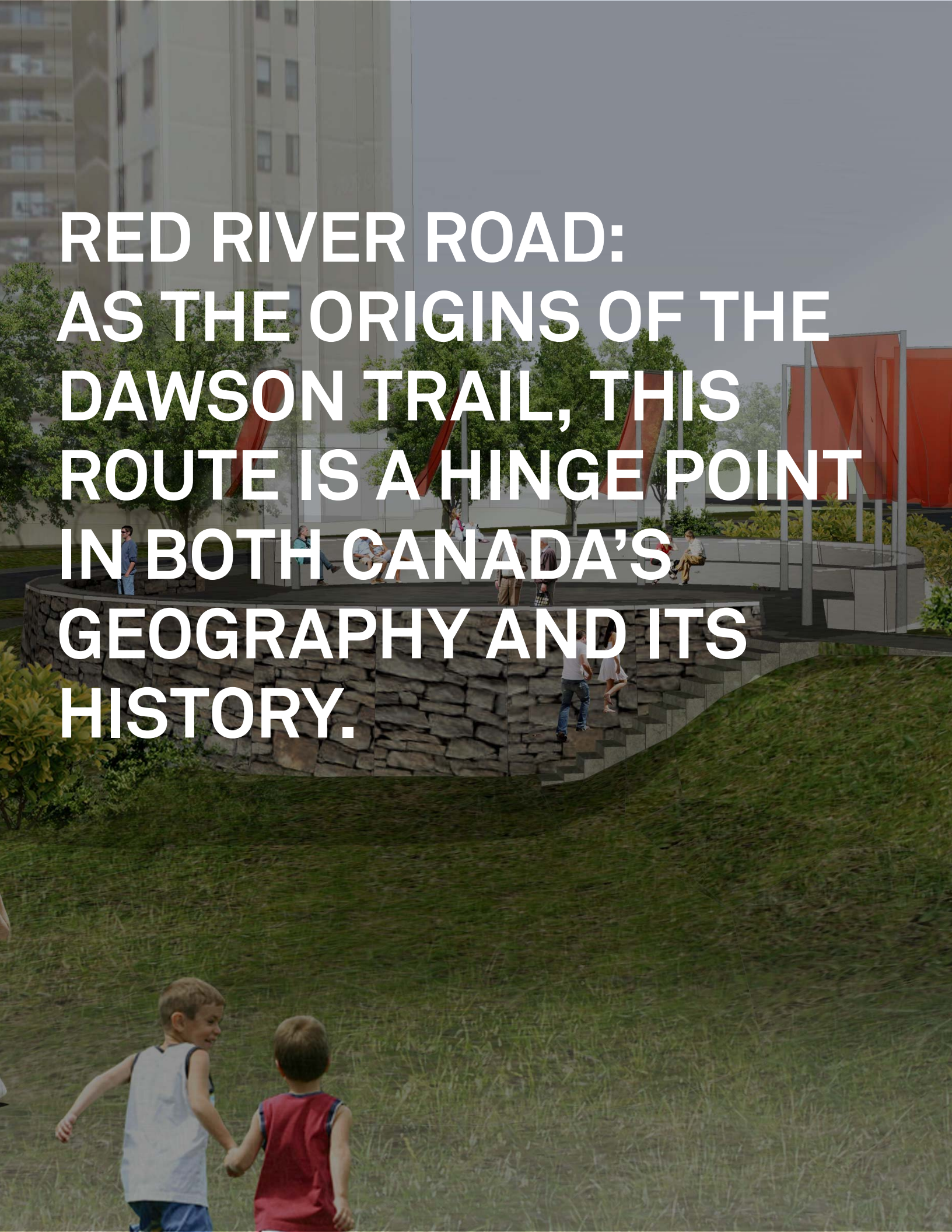

5.3 Red River Road/the North Core

Theme: A Gateway to Canada

Red River Road undulates east-west through the north area of the city and beckons back to its origins as the Dawson Trail. This is the route that linked the Great Lakes to Western Canada – a hinge point in both Canada’s geography and its history.

Character:

Red River Road will resemble a ‘String of Pearls’ where small pocket parks and orphan spaces along the route will be transformed into beautiful open spaces through public art, landscaping, and other public realm improvements.

Design Approach:

Interpreting the Dawson Trail

The public art installations along the Image Route will tell a linear story that will represent the history of movement through the area, focusing on the role of the Dawson Trail, culminating at Prince Arthur’s Landing, including:

- Samuel James Dawson
- A typical journey along the Dawson Trail
- The completion of the trail in 1871
- The Red River Expedition
- The impact of the Canadian Pacific Railway on the City and the Trail

Reflect the Existing Heritage

Red River Road, and particularly the area surrounding the North Core, is the most significant heritage area in the City of Thunder Bay. New development and enhancements to the streetscape should carefully respond to, but not mimic, this historic context. For example, at Water Street, Red River Road will provide a direct pedestrian crossing to the waterfront and the historic Baggage Building.

Consider the Varied Topography

Red River Road has a varied topography, sloping significantly towards Lake Superior, but levelling out at key locations. For pedestrians travelling west along Red River Road, the new and enhanced open spaces will feature areas to sit and rest.

Because of this slope, Red River Road affords spectacular views of Lake Superior, the North Core, and the Sleeping Giant. Newly redesigned parks and open spaces will capitalize on this great opportunity through seating areas, lookout points, information signage, etc.

The illustrations that follow demonstrate the detailed streetscape designs for Red River Road. For descriptions of the recommendations, please refer to Section 3.0: Design Tools.



Red River Road - Material Palette

Precast Concrete Unit Pavers



Precast concrete unit pavers for decorative paving strip between sidewalk and curb.

Colour: Heritage Brown

Finish: Premium Finish (i.e. brushed, exposed aggregate, tumbled or standard broom)

Paver Size: 8"x 8"

Pattern: Running Bond, parallel to road (to minimize cutting)

Example Product: 8"x 8" Unilock Il Campo in Heritage Brown (shown)

Bench



Durable metal bench with end and centre arms. Simple, timeless design. Mid-range price point.

Colour: Black

Finish: Glossy

Size: 72" (6'-0")

Installation Method: Surface Mount

Example Product: landscapeforms Village Green (shown)

Trash/Recycling Receptacle



Paired garbage & recycling units. Durable, simple design to match bench. Side opening for easy access. Covered top to shield from rain and snow.

Colour: Black

Finish: Glossy

Installation Method: Surface Mount

Options: Concealed latch; plastic liner with drain holes

Example Product: Victor Stanley SDC-36 (shown in grey)

Tree Grate



Cast-iron tree grate at each street tree.

Colour: Natural Cast-iron Patina

Finish: Raw cast-iron

Size: 4'x6' (or to fit site condition)

Pattern: Radial #1

Example Product: Urban Accessories Kiva (shown)

Tree Guard



Simple tree guard to protect young trees from damage from snow removal equipment, bicycles, etc. Black colour to match bench and trash receptacles.

Colour: Black

Finish: Glossy

Size:

Installation Method: Bolt-on to tree grate

Example Product: Custom Urban Accessories Unit (shown)

Gateway Signage



For Red River Road, it is recommended that the gateway signage act as a symbolic representation of the Dawson Trail and a gateway to the Waverley Heritage Area. The gateway elements as proposed are to be slender tapering granite poles that are designed to emphasize the verticality of the landscape and to minimize visual obstructions to the lake and the sleeping giant.

Gateway signage should be used only at key sites as identified in this document. Such locations should include St Patrick Square, the entrance to the City from the Expressway, and the entrance to the South Core. All gateway signage, at the expressway, will need to be approved by relevant Provincial Regulating bodies.

Banners



Banners are recommended, in key focus areas, along the Image Routes. Generally, the banner programs should be maintained by the local BIA groups and should be coordinated and approved by the City.

There are two approaches to banner installations. One such approach is for vehicles and the other for pedestrians. Banners should be focused in key areas throughout the Image Routes. Banners for vehicles should be installed at gateway locations, where significant traffic exists, such as Red River Road and the Thunder Bay Expressway. Banners for pedestrians should be installed at areas where events and festivals are held, such as Red River Road/Algoma Street and the North Core. Pole and lighting fixture selection should consider the accommodation of future banners, and should allow for integrated hardware to support the banners.

Wayfinding

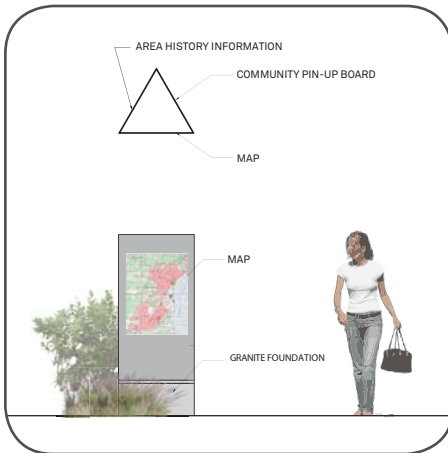

Wayfinding signage is important in order to identify the location of nearby landmarks, or other amenities. Such signage should also speak to the area history and provide information related to community events.

Generally, wayfinding markers should be reserved for areas with high pedestrian and cyclist traffic, and should be placed at key locations along the length of Red River Road, including Water Street and Red River, and Waverley Park.

The markers are recommended to be three-sided, and could be comprised of cast steel poles with steel panels. Wayfinding information could include an area map with key destinations, community pin-up board and information about the image route vision. The markers are recommended to be mounted on top of a granite foundation to ensure longevity and ease of maintenance as well as to ensure consistency with the design of gateway markers.

Pedestrian Lighting



A consistent approach for street and pedestrian lighting is recommended for all of the image routes. Using a similar fixture style throughout will allow for ease of maintenance and will maximize the City's value for dollar. In special character areas, including park areas and main street character areas, such as the North Core, Algoma Street and Waverley Park, pedestrian lighting is recommended to provide for a safe and inviting pedestrian environment.



Red River Road: Before



Red River Road: After

**HIGHWAY 102
DAWSON ROAD**

**THUNDER BAY
EXPRESSWAY**

**RED RIVER
ROAD**



**Recommended
Improvements**

- Street Trees -
Page 19

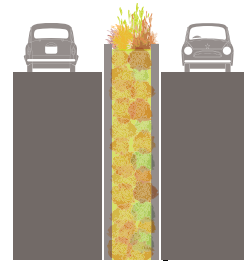

**Recommended
Improvements**

- Green Median -
Page 21

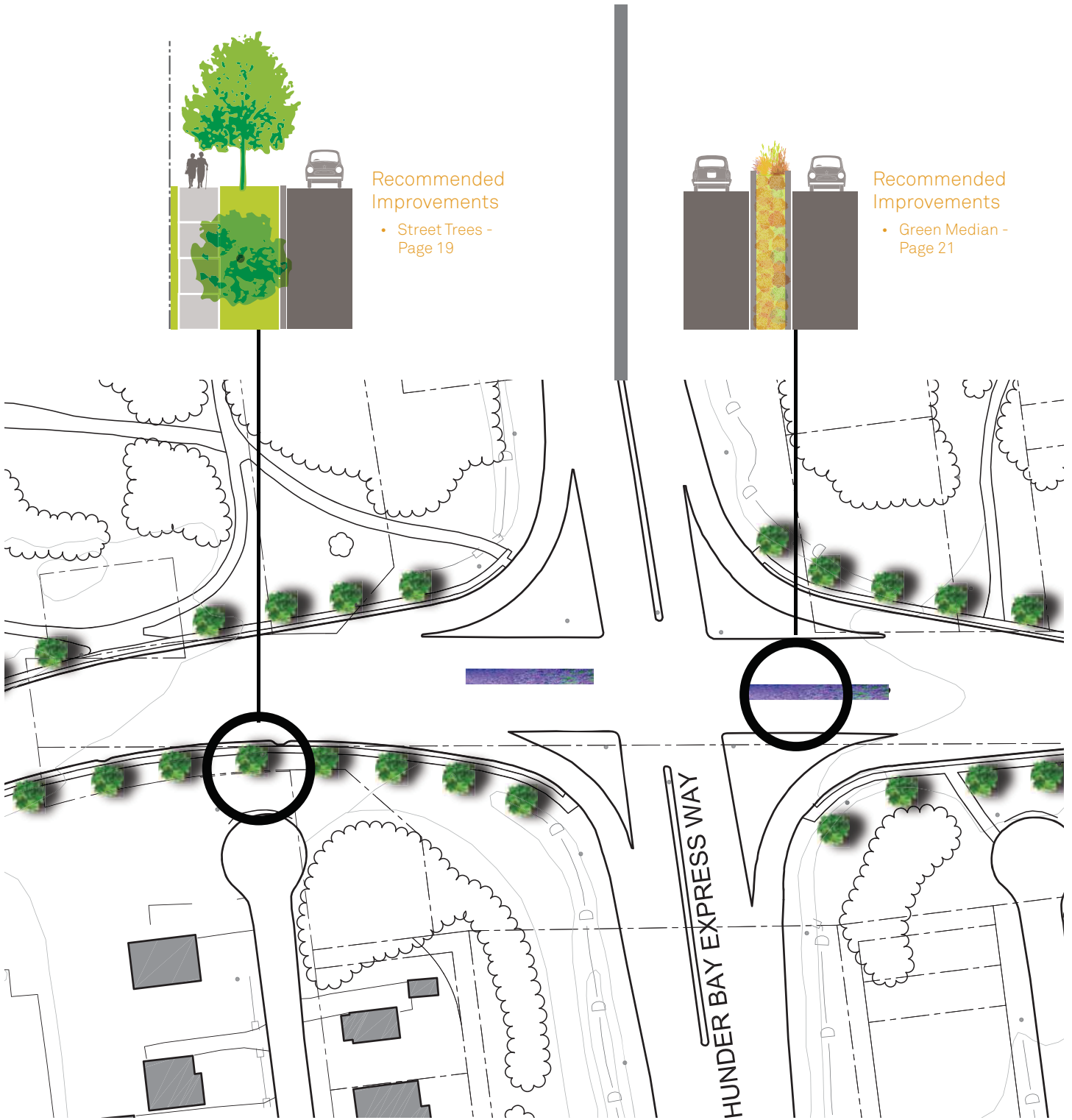

Dawson Road / Red River Road

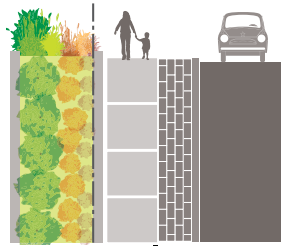

Recommended Improvements

- Screen Planting - Page 27



Red River Road



JUNOT AVENUE

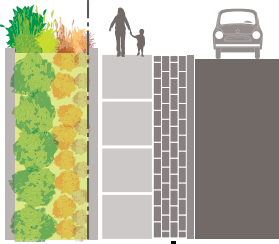

Recommended Improvements

- Boulevard Improvements - Page 25
- Screen Planting - Page 27



Red River Road

CLARKSON STREET

Recommended Improvements

- Screen Planting - Page 27
- Private Trees - Page 22



Red River Road



CLARKSON STREET



Recommended Improvements

- Boulevard Improvements - Page 25
- Small Opportunity Sites - Page 28

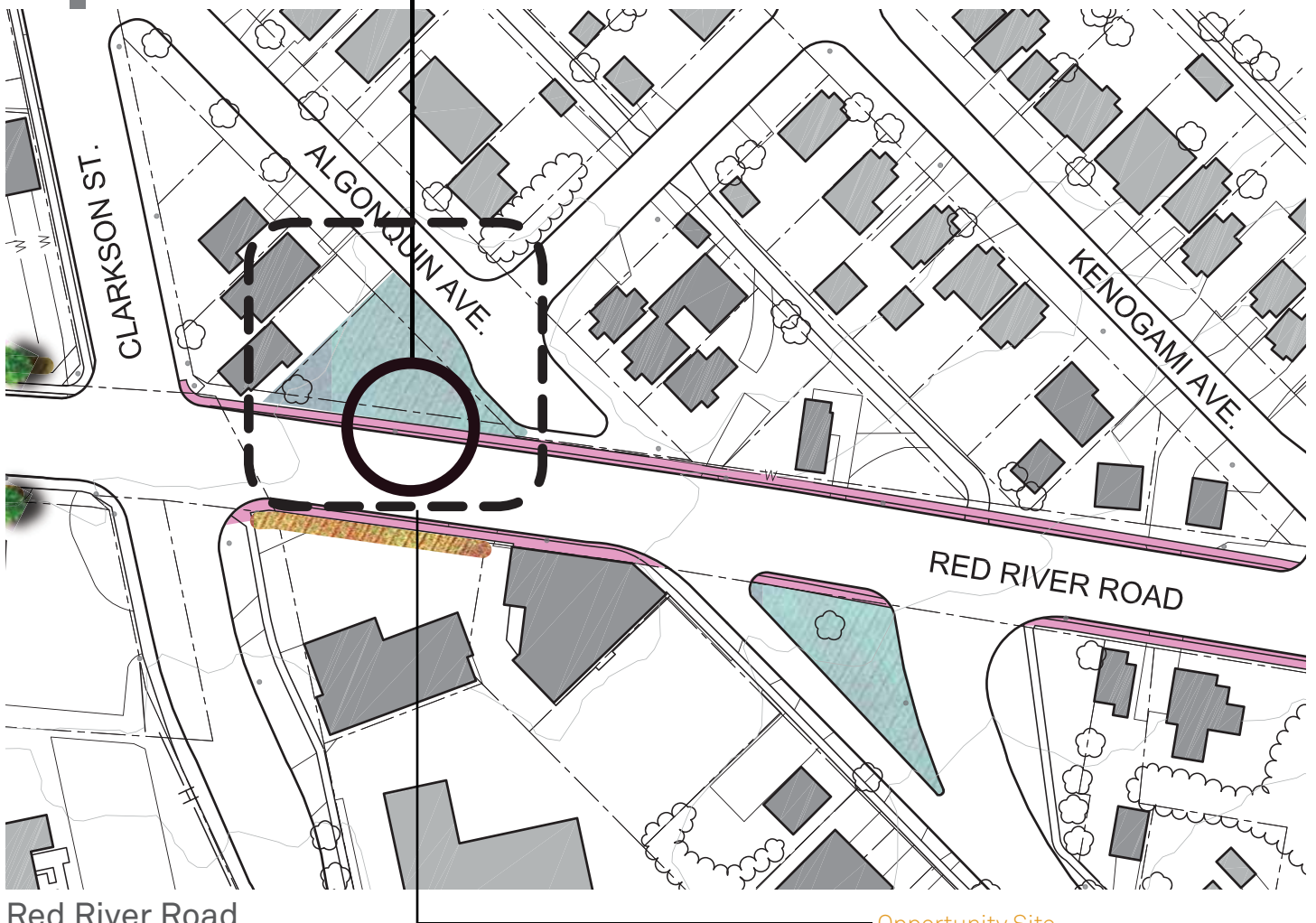

Red River Road

Opportunity Site

- See Page 34



Red River Road





Recommended Improvements

- Boulevard Improvements - Page 25
- Private Trees - Page 22

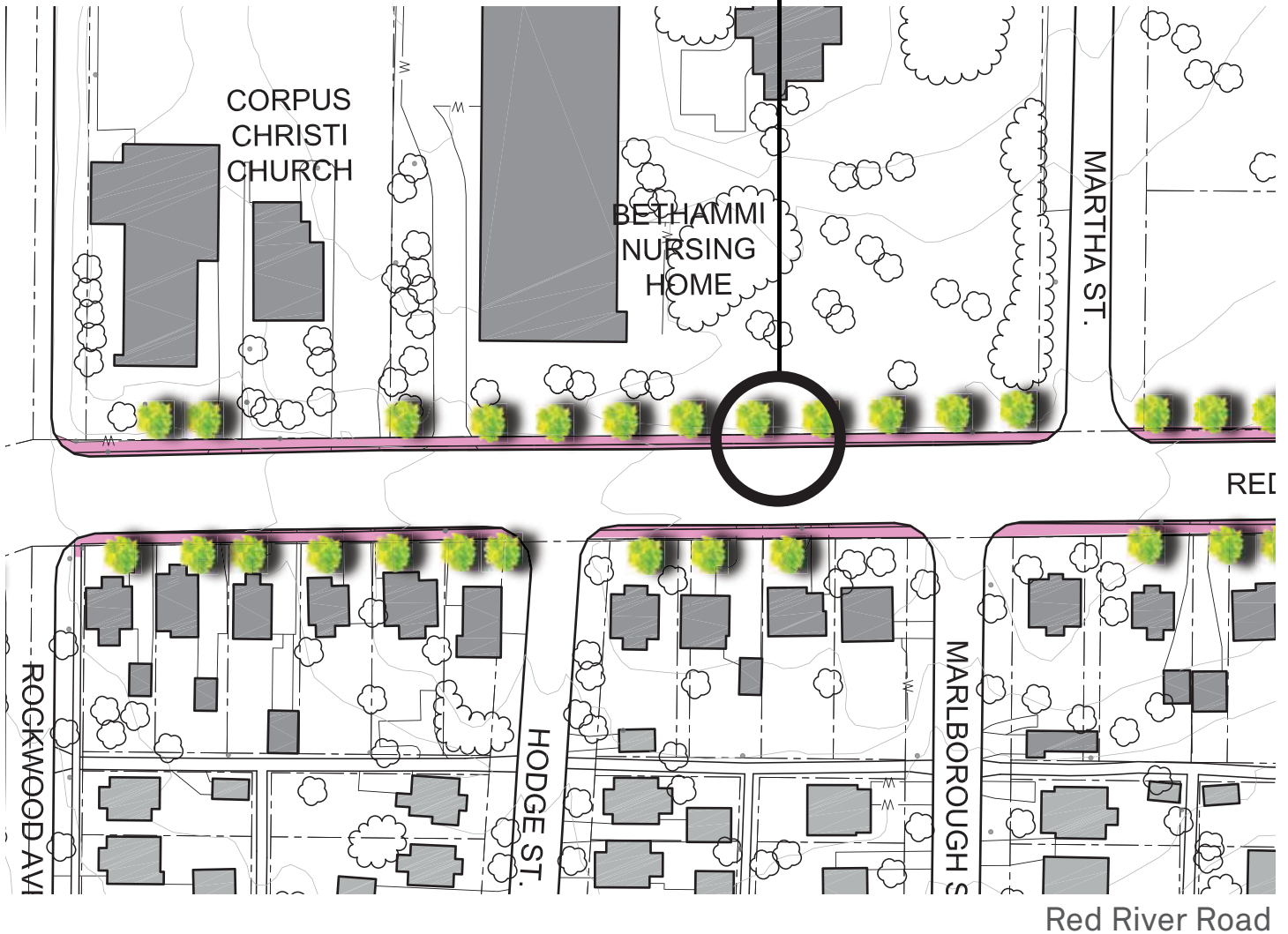

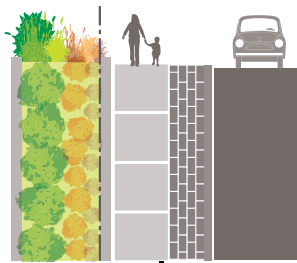

Recommended Improvements

- Boulevard Improvements - Page 25
- Screen Planting - Page 27
- Private Trees - Page 22

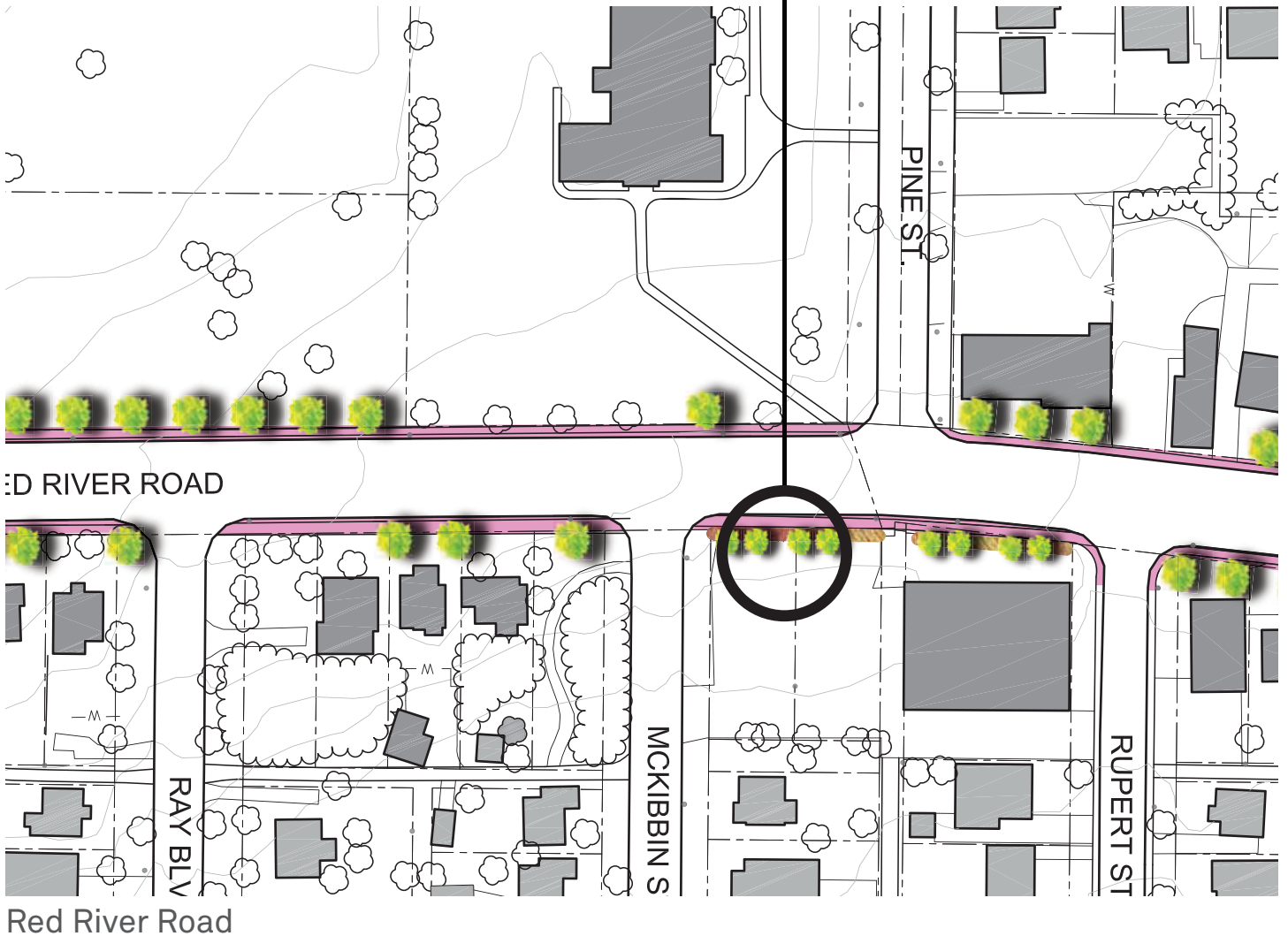

Recommended Improvements

- Boulevard Improvements - Page 25
- Private Trees - Page 22



Red River Road



HIGH STREET



Recommended Improvements

- Boulevard Improvements - Page 25
- Private Trees - Page 22

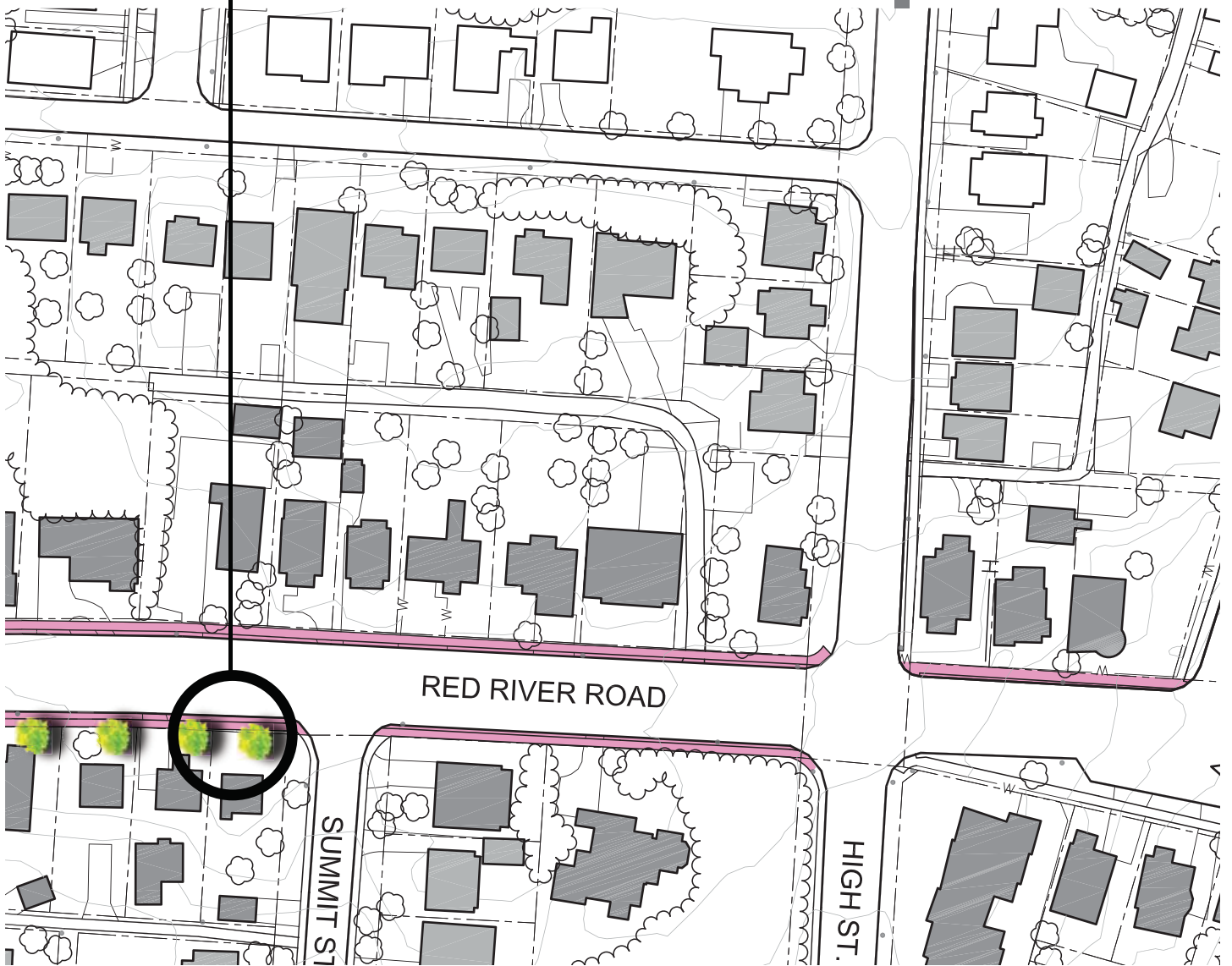

Red River Road

Recommended Improvements

- Small Opportunity Sites - Page 28



Recommended Improvements

- Street Trees - Page 19
- Private Trees - Page 22
- Boulevard Improvements - Page 25

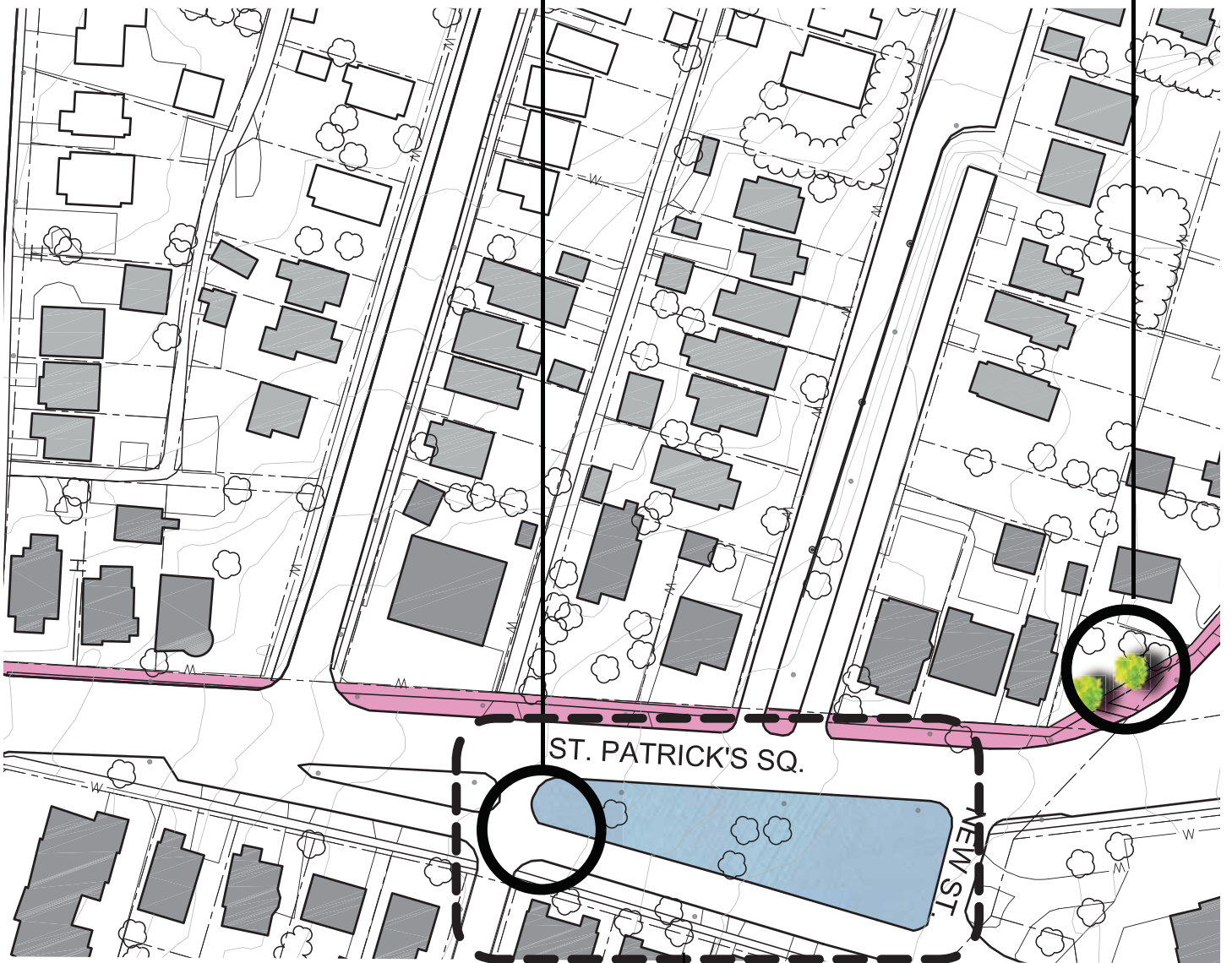

ST. PATRICK'S SQ.

NEW ST.

Red River Road

St Patrick Square
Demonstration Site

- See Page 44





Red River Road

Waverley Park
Demonstration Site

• See Page 45

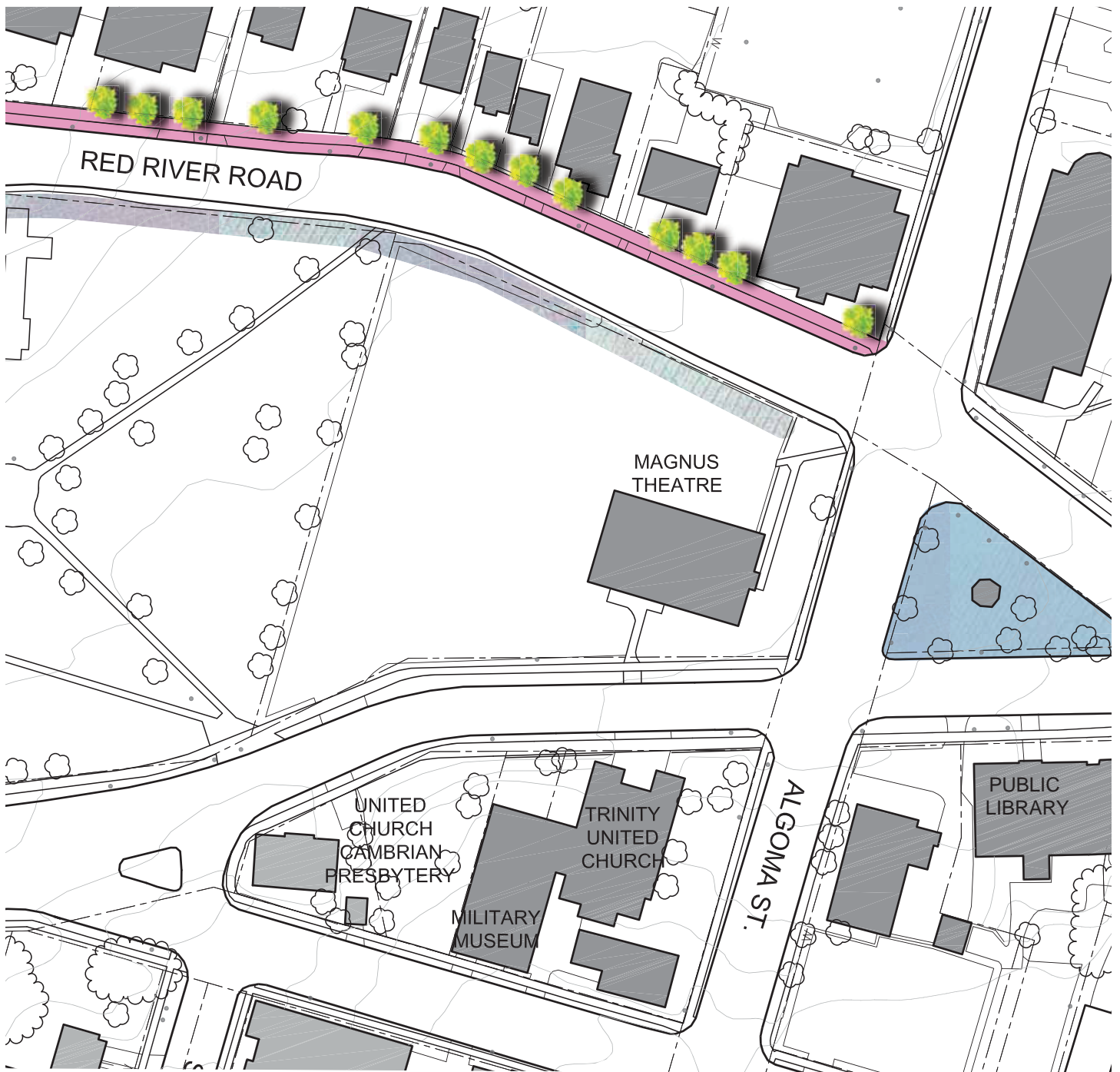

Red River Road / Algoma Street



ALGOMA STREET



Recommended Improvements

- Small Opportunity Sites - Page 28



Recommended Improvements

- Private Trees - Page 22
- Boulevard Improvements - Page 25
- Screen Planting - Page 27

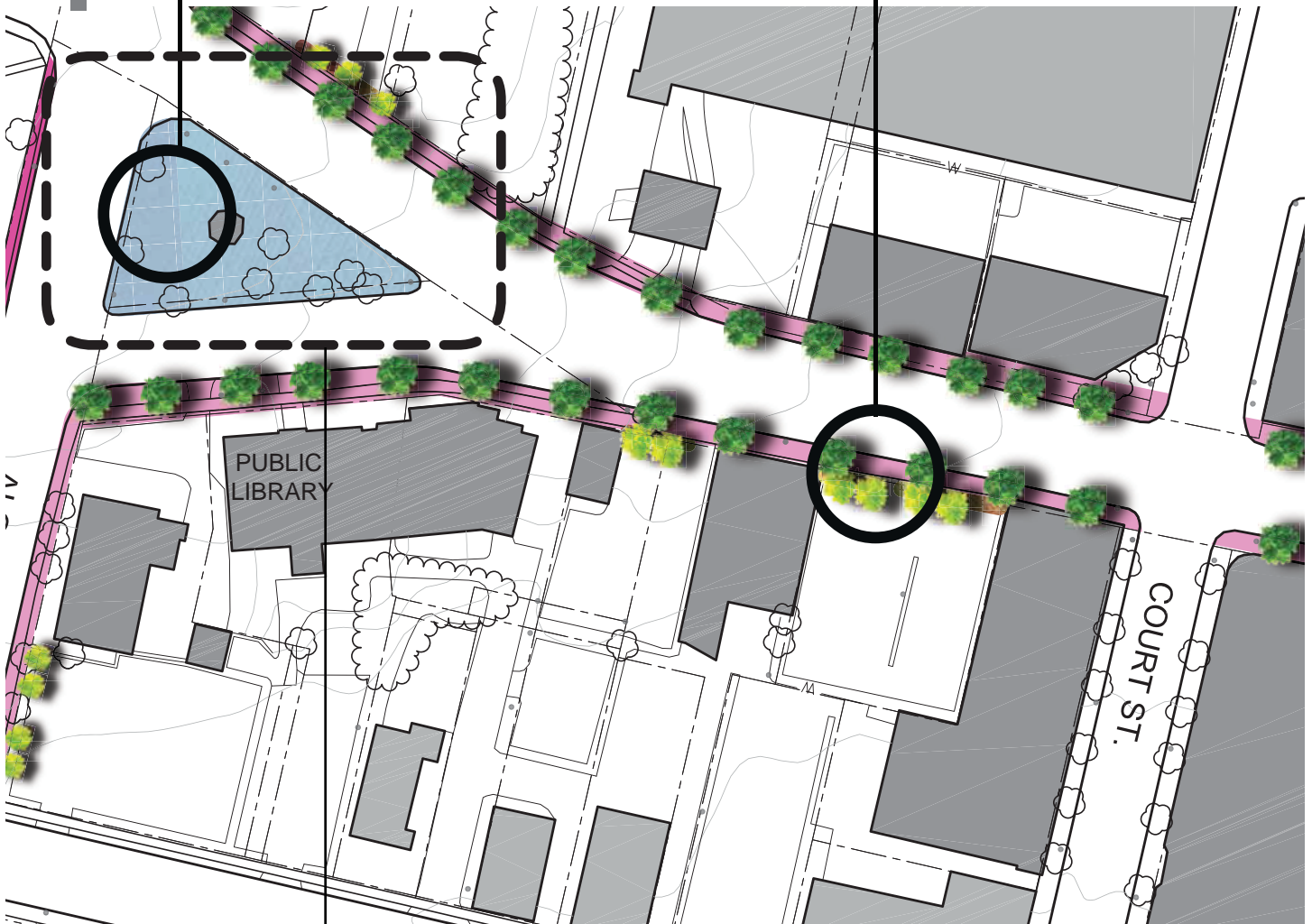

Red River Road

Connaught Park
Demonstration Site

- See Page 47



Recommended Improvements

- Street Trees - Page 19
- Boulevard Improvements - Page 25

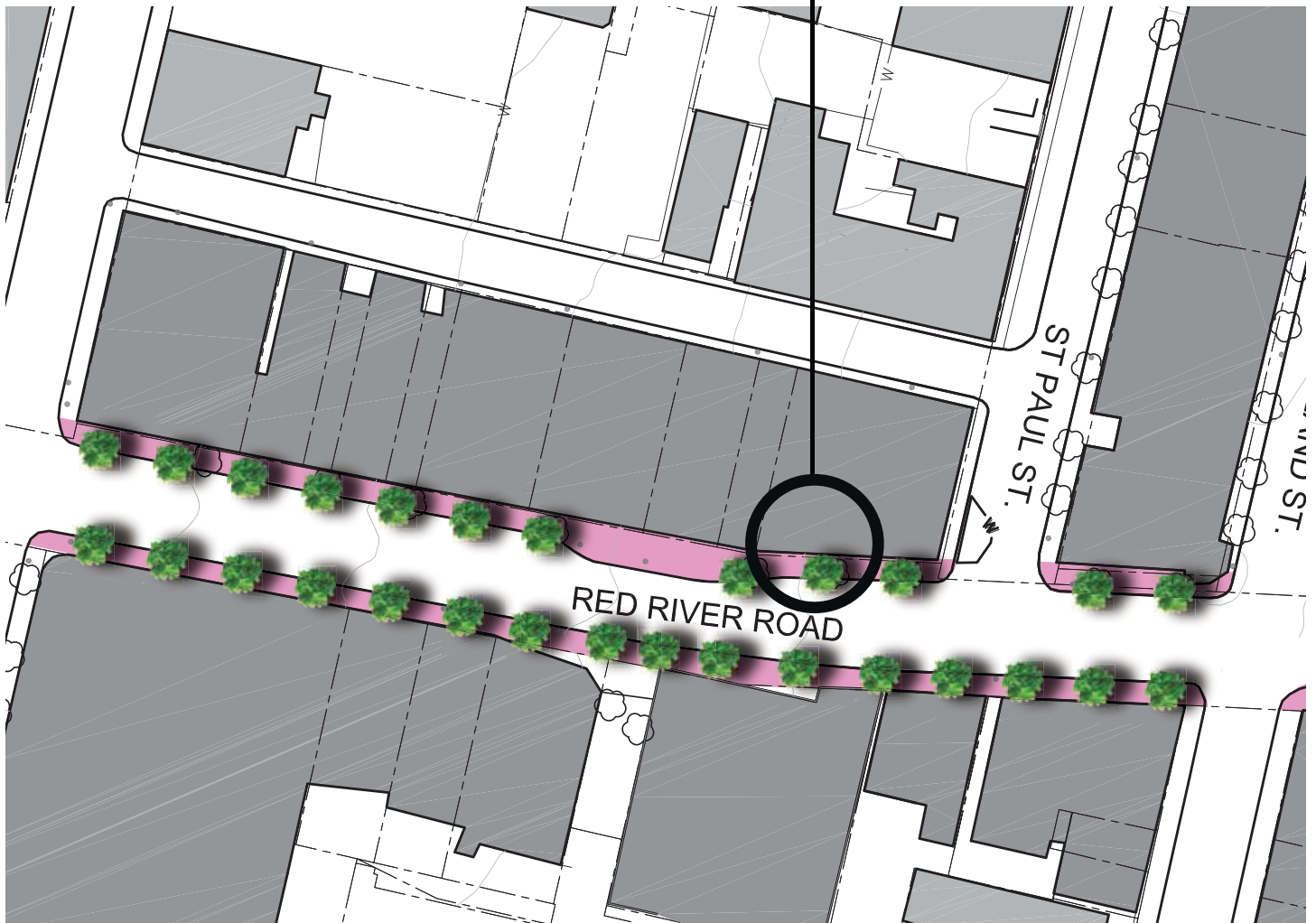

Red River Road



WATER STREET



Recommended Improvements

- Street Trees - Page 19
- Boulevard Improvements - Page 25
- Small Opportunity Sites - Page 28



Red River Road

Red River Road
(from Cumberland to Water Streets)
Demonstration Site

- See Page 49



